



SC – 56084



Two filters  
required per  
service

## Application

2014-2015 Jeep Grand Cherokee 3.0L Turbo Diesel “Ecodiesel”

### Location

The fuel filter/water separator is located underneath the vehicle, on the left side, in front of the fuel tank and under the transfer case skid plate.

### Filter Replacement Service Procedures

**Note: This vehicle has two fuel filters located side by side. Both must be replaced.**

- A. Stop the vehicle and turn off the engine. This vehicle is equipped with push button start. To prevent accidental start up by anyone remaining in the vehicle during service, remove the key fob from vehicle.

**Note:** Ensure the vehicle has adequate amount of fuel in the fuel tank before the service as adequate fuel is required for the final priming process.

- B. Remove skid plate (circled below). Locate the fuel filter/water separator housing above it.

Vehicle Undercarriage (Housing location circled)

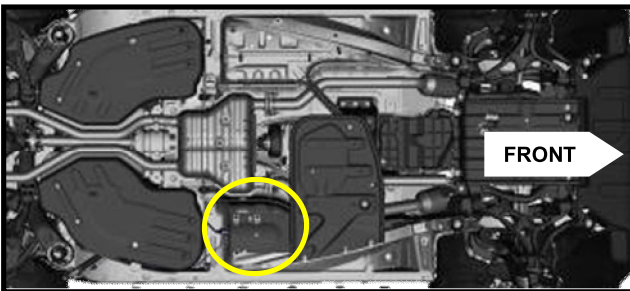

Fuel Filter/Water Separator Housing

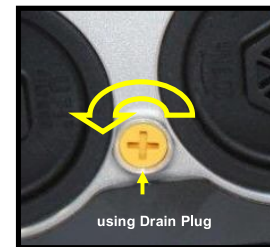

- C. Drain fuel filter/water separator housing. To control spillage, place a catch basin underneath the fuel filter/water separator housing. Using a large Phillips screwdriver, loosen the housing drain plug (turning counterclockwise) to empty the housing of any water and fuel. Once drained, tighten the drain plug. Be careful not to over-tighten the plug. Wipe up any spilled fuel.

- D. With the housing drained, the two fuel filters may now be removed. Ensure the catch basin is still in place. Loosen and remove the first housing cap. To do this, use appropriate socket with a 3/8” ratchet and turn the housing cap counterclockwise.



- E. Once the housing cap is loose, remove cap by hand and pull cap and attached filter down. Discard old fuel filter, housing cap and cap o-ring.

- F. Repeat same removal process with the second filter.
- G. With both fuel filters removed, wipe the housing sealing surfaces and housing bottom clean.
- H. The new fuel filters include a new attached housing cap and installed housing cap o-ring.

- I. Lubricate housing cap o-ring (pictured bottom left) with **engine oil** and the fuel filter's top end cap grommet with **diesel fuel** (pictured bottom right).

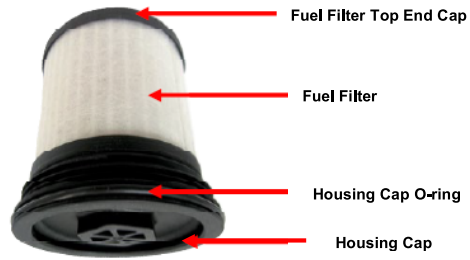

- J. Install both new fuel filters. Be careful not to over tighten the housing cap during installation. Housing cap torque specification is 20 Nm (177 in/lbs).
- K. Wipe up any spilled fuel. Double-check housing cap drain plug and housing cap are tight.

**Priming**

**Once the two fuel filters have been installed the fuel system must be primed before the vehicle can be started.**

**This Vehicles Has Push Button Start (Ensure Key Fob is in Vehicle) - Read Carefully**

1. **Without depressing the brake pedal**, press the "START/STOP" button twice to put ignition system in "RUN" position. The vehicle should not be running at this time. This will activate the in-tank fuel pump for approximately 30 seconds. After the 30 seconds, press the "START/STOP" button once to turn the ignition system "OFF".
2. Repeat this priming process two times in total. This will ensure the fuel filter housing is full of fuel before starting the vehicle.
3. Start the engine by depressing and holding the brake pedal and then pressing the "START/STOP" button once. Allow the vehicle to run for a few minutes. In most cases the engine will start right away. In others, the engine will start but may initially run rough. This may occur briefly as the engine purges trapped air from the fuel system. Check the filter housing for leaks while the vehicle is running.

- L. Re-install skid plate.

**Disclaimer:**

Although the information contained within these instructions have been obtained from sources generally believed to be reliable, no warranty (expressed or implied) can be made as to its accuracy or completeness, nor is any responsibility assumed by Service Champ or anyone connected with it for loss or damages suffered through reliance on any information contained in these instructions. In no event will Service Champ be liable for any damages, direct or indirect, consequential or compensatory, including, without limitation, lost profits, for any representations, breaches or defaults arising out of the use of these instructions. Customer agrees to indemnify Service Champ and hold it harmless against all claims and damages, including without limitation, reasonable attorney's fees arising out of the use of these instructions.

**Copyright:**

No part of this publication may be reproduced, stored in a retrieval system, or transmitted in any form or by any means, electronic, mechanical, photocopying, recording, or otherwise, without the prior written permission of the copyright holder.